

# Retaining Rings-C Type JIS B 2804

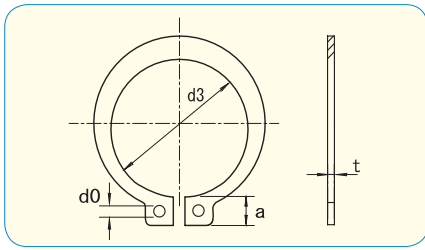

● **Material**  
Stainless Steel A2



How to order or inquire: R830-B2804EX-A2 diameter Example: R830-B2804EX-A2 10

	Box q'ty	SIZE				pcs / Box
		d3	t	a	d0	
M3.2	2000	2.7	0.25	1.7	0.7	
M4	2000	3.7	0.4	2.2	0.8	
M5	2000	4.7	0.6	2.4	0.8	
M6	2000	5.6	0.7	2.8	1	
M7	2000	6.5	0.8	3	1	
M8	2000	7.4	0.8	3	1	
M9	2000	8.4	1	3.2	1	
M10	2000	9.3	1	3	1.2	
M11	2000	10.2	1	3.1	1.2	
M12	2000	11.1	1	3.2	1.5	
M13	2000	12	1	3.3	1.5	
M14	2000	12.9	1	3.4	1.7	
M15	2000	13.8	1	3.5	1.7	
M16	2000	14.7	1	3.6	1.7	
M17	2000	15.7	1	3.7	1.7	
M18	1000	16.5	1.2	3.8	1.7	
M19	1000	17.5	1.2	3.8	2	
M20	1000	18.5	1.2	3.9	2	
M21	1000	19.5	1.2	4	2	
M22	1000	20.5	1.2	4.1	2	
M23	1000	21.4	1.2	4.5	2	
M24	500	22.2	1.2	4.2	2	
M25	500	23.2	1.2	4.3	2	
M26	500	24.2	1.2	4.4	2	
M28	500	25.9	1.5	4.6	2	
M29	500	26.9	1.5	4.7	2	
M30	400	27.9	1.5	4.8	2	
M32	400	29.6	1.5	5	2.5	
M34	300	31.5	1.5	5.3	2.5	
M35	300	32.2	1.5	5.4	2.5	
M36	200	33.2	1.75	5.4	2.5	
M38	200	35.2	1.75	5.6	2.5	
M40	200	37	1.75	5.8	2.5	
M42	200	38.5	1.75	6.2	2.5	
M45	200	41.5	1.75	6.3	2.5	
M48	100	44.5	1.75	6.5	2.5	
M50	100	45.8	2	6.7	2.5	
M52	100	47.8	2	6.8	2.5	
M55	100	50.8	2	7	2.5	
M56	100	51.8	2	7	2.5	
M58	100	53.8	2	7.1	2.5	
M60	100	55.8	2	7.2	2.5	
M62	100	57.8	2	7.2	2.5	
M63	100	58.8	2	7.3	2.5	
M65	50	60.8	2.5	7.4	2.5	
M68	50	63.8	2.5	7.8	2.5	

	Box q'ty	SIZE				pcs / Box
		d3	t	a	d0	
M70	50	65.5	2.5	7.8	2.5	
M72	50	67.5	2.5	7.9	2.5	
M75	50	70.5	2.5	7.9	2.5	
M78	50	73.5	2.5	8.1	2.5	
M80	50	74.5	2.5	8.2	2.5	
M82	50	76.5	2.5	8.3	3	
M85	50	79.5	3	8.4	3	
M90	50	84.5	3	8.7	3	
M95	50	89.5	3	9.1	3	
M100	50	94.5	3	9.5	3	
M110	50	103	4	10	3	
M120	1	113	4	10.9	3	
M150	1	142	4	12.3	3.5	
M160	1	151	4	12.9	3.5	
M200	1	190.5	4		4	

# Retaining Rings-C Type JIS B 2804

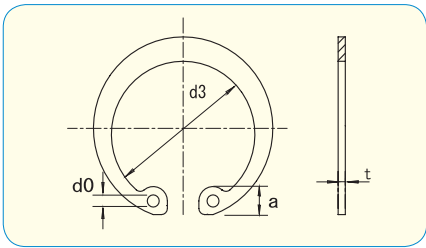

●Material  
Stainless Steel A2



How to order or inquire: R830-B2804IN-A2 diameter Example: R830-B2804IN-A2 10

	Box q'ty	SIZE				pcs / Box
		d3	t	a	d0	
M6.4	2000	6.9	0.4	1.6	0.8	
M8	2000	8.6	0.4	1.7	0.8	
M9.5	2000	10.3	0.6	2.1	1	
M10	2000	10.7	1	2.8	1.2	
M11	2000	11.8	1	3	1.2	
M12	2000	13	1	3.1	1.5	
M13	2000	14.1	1	3.1	1.5	
M14	2000	15.1	1	3.6	1.7	
M15	2000	16.2	1	3.6	1.7	
M16	2000	17.3	1	3.7	1.7	
M17	2000	18.3	1	3.8	1.7	
M18	2000	19.5	1	4	1.7	
M19	2000	20.5	1	4	2	
M20	1000	21.5	1	4	2	
M21	1000	22.5	1	4.1	2	
M22	1000	23.5	1	4.1	2	
M24	1000	25.9	1.2	4.3	2	
M25	500	26.9	1.2	4.4	2	
M26	500	27.9	1.2	4.6	2	
M28	500	30.1	1.2	4.6	2	
M30	500	32.1	1.2	4.7	2	
M32	500	34.4	1.2	5.2	2.5	
M34	300	36.5	1.5	5.2	2.5	
M35	300	37.8	1.5	5.2	2.5	
M36	300	38.8	1.5	5.2	2.5	
M37	200	39.8	1.5	5.2	2.5	
M38	200	40.8	1.5	5.3	2.5	
M40	200	43.5	1.75	5.7	2.5	
M42	200	45.5	1.75	5.8	2.5	
M45	200	48.5	1.75	5.9	2.5	
M46	200	49.7	1.75	6.1	2.5	
M47	200	50.5	1.75	6.1	2.5	
M48	100	51.5	1.75	6.2	2.5	
M50	100	54.2	2	6.5	2.5	
M52	100	56.2	2	6.5	2.5	
M55	100	59.2	2	6.5	2.5	
M56	100	60.2	2	6.6	2.5	
M58	100	62.2	2	6.8	2.5	
M60	100	64.2	2	6.8	2.5	
M62	100	66.2	2	6.9	2.5	
M63	100	67.2	2	6.9	2.5	
M65	50	69.2	2.5	7	2.5	
M68	100	72.5	2.5	7.4	2.5	

	Box q'ty	SIZE				pcs / Box
		d3	t	a	d0	
M70	50	74.5	2.5	7.4	2.5	
M72	50	76.5	2.5	7.4	2.5	
M75	50	79.5	2.5	7.8	2.5	
M78	50	82.5	2.5	8	2.5	
M80	50	85.5	2.5	8	2.5	
M82	50	87.5	2.5	8	3	
M85	50	90.5	3	8	3	
M90	50	95.5	3	8.3	3	
M95	50	100.5	3	8.5	3	
M100	50	105.5	3	8.8	3	
M110	1	117	4	10.2	3	
M120	1	127	4	10.7	3	
M150	1	158	4	11.8	3.5	
M160	1	169	4	12.5	3.5	
M200	1	209.5	4		4	

NOTE: Zinc 3Cr. Plated and Black 3Cr. Plated are RoHS compliant trivalent finishes

## Retaining Rings-E Type JIS B 2804

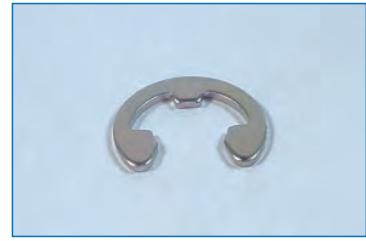
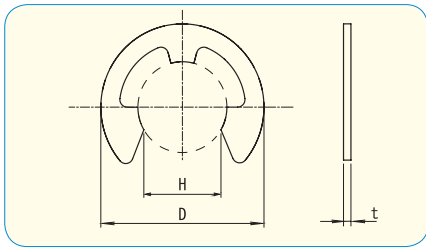

How to order or inquire: R830-B2804ER-CR3 diameter  
Example: R830-B2804ER-CR3 10

- **Material - plating**  
Steel / Zinc 3Cr. Plated

How to order or inquire: R830-B2804ER-A2 diameter  
Example: R830-B2804ER-A2 10

- **Material**  
Stainless Steel A2

	Box q'ty	SIZE		
		D	H	t
M1.5	2000	4	1.3	0.4
M2	2000	5	1.7	0.4
M2.5	2000	6	2.1	0.4
M3	2000	7	2.6	0.6
M4	2000	9	3.5	0.6
M5	2000	11	4.3	0.6
M6	2000	12	5.2	0.8
M7	2000	14	6.1	0.8
M8	2000	16	6.9	0.8
M9	2000	18	7.8	0.8
M10	2000	20	8.7	1
M12	1000	23	10.4	1
M15	500	29	13	1.6

	Box q'ty	SIZE		
		D	H	t
M0.8	2000	2	0.7	0.2
M1.2	2000	3	1	0.3
M1.5	2000	4	1.3	0.4
M2	2000	5	1.7	0.4
M2.5	2000	6	2.1	0.4
M3	2000	7	2.6	0.6
M4	2000	9	3.5	0.6
M5	2000	11	4.3	0.6
M6	2000	12	5.2	0.8
M7	2000	14	6.1	0.8
M8	2000	16	6.9	0.8
M9	2000	18	7.8	0.8
M10	2000	20	8.7	1
M12	1000	23	10.4	1
M15	500	29	13	1.6
M19	400	37	16.5	1.6
M24	200	44	20.8	2