

NOTE: Zinc 3Cr. Plated and Black 3Cr. Plated are RoHS compliant trivalent finishes

HEX SOCKET BUTTON HEAD SCREW ISO 7380 / JIS B1174

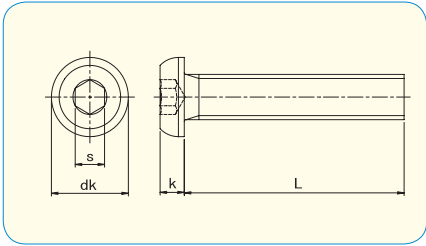

- **Material · plating**
- Steel 10.9 / Zinc 3Cr. Plated
- Steel 10.9 / Zinc Black 3Cr. Plated



How to order or inquire: R830-7380-finish code diameter x length

Example: R830-7380-CR3 4x10

Finish codes: CR3 for Zinc 3Cr. Plated, CR3B for Black 3Cr. Plated

	M3	M4	M5	M6	M8	M10
dk	5.7	7.6	9.5	10.5	14	17.5
k	1.65	2.2	2.75	3.3	4.4	5.5
s	2	2.5	3	4	5	6

		pcs / Box					
L \ d	M3	M4	M5	M6	M8	M10	
5	1000	1000					
6	1000	1000	400	400			
8	1000	1000	400	400			
10	1000	1000	400	400	200		
12	1000	1000	400	200	100		
14	1000	1000	400	200	100		
15	1000	1000	400	200	100	100	
16	1000	1000	400	200	100	100	
18	1000	1000	200	200	100	100	
20	1000	1000	200	200	100	100	
25	800	800	200	200	100	100	
30	800	800	200	100	100	100	
35	800	600	200	100	100	100	
40	800	600	200	100	100	100	
45		600	200	100	100	100	
50		600	200	100	100	50	
55			200	100	100	50	
60			200	100	100	50	
65				100	100	50	
70					100	50	

HEX SOCKET BUTTON HEAD SCREW ISO 7380 / JIS B1174

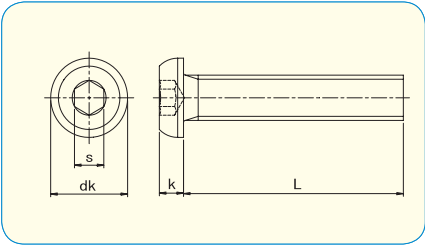

● **Material**
Stainless Steel A2



How to order or inquire: R830-7380A2 diameter x length

Example: R830-7380A2 4x16

Material codes: A2 for Stainless Steel A2

	M3	M4	M5	M6	M8	M10	M12	M16
dk	5.7	7.6	9.5	10.5	14	17.5	21	28
k	1.65	2.2	2.75	3.3	4.4	5.5	6.6	8.8
s	2	2.5	3	4	5	6	8	10

		pcs / Box							
L \ d	M3	M4	M5	M6	M8	M10	M12	M16	
3									
4	500								
5	500	500							
6	500	500	500						
8	500	500	500	300					
10	500	500	500	300	200				
12	500	500	500	300	200	100			
14	500	500	500	300	200				
15	500	500	500	300	200	100			
16	500	500	500	300	200	100	100		
18	500	500	500	300	200				
20	500	500	500	300	200	100	100		
22	500	500	500	300	200	100			
25	500	500	500	300	200	100	100	20	
30	500	500	500	300	200	100	100	20	
35	500	500	500	300	200	100	100	20	
40	500	500	500	300	200	100	100	20	
45	500	500	500	300	200	100	100	20	
50	500	500	500	300	200	100	100	20	
55		500	500	300	200	100	100	20	
60		500	500	300	200	100	100	20	
65			500	300	200	100	100	20	
70			500	300	200	100	100	20	
75			500	300	200	100	100	20	
80			500	300	200	100	100	20	
85						100	100	20	
90				300	200	100	100	20	
95								20	
100				300	200	100	100	20	



HEX SOCKET BUTTON HEAD SCREW ISO 7380 / JIS B1174

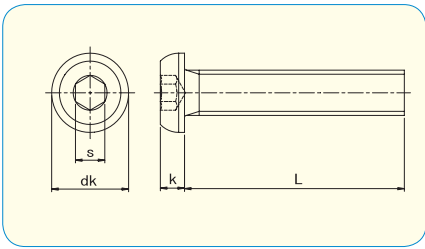

● **Material**
TITAN



How to order or inquire: R830-7380-material code diameter x length
Example: R830-7380-TI 4x16

Material codes: TI for Titanium

	M3	M4	M5	M6	M8
dk	5.7	7.6	9.5	10.5	14
k	1.65	2.2	2.75	3.3	4.4
s	2	2.5	3	4	5

		pcs / Box				
L \ d	M3	M4	M5	M6	M8	
6	1000					
8	1000	1000	1000	500		
10	1000	1000	500	500		
12	1000	1000	500	500	200	
15	1000	1000	500	500	200	
16	1000	1000	500	500	200	
20	1000	1000	500	500	200	
25		1000	500	500	200	
30		1000	500	500	200	

TITAN

HEX SOCKET FLAT HEAD SCREW JIS B1194 / DIN 7991

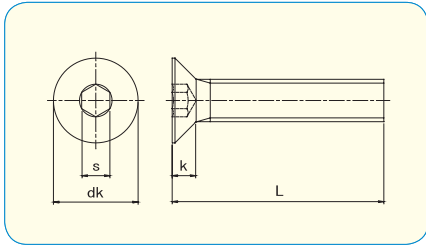

How to order or inquire: R830-7991-finish code diameter x length

Example: R830-7991-CR3 4x10

Finish codes: CR3 for Zinc 3Cr. Plated, CR3B for Black 3Cr. Plated

	M3	M4	M5	M6	M8	M10
dk	6.72	8.96	11.2	13.44	17.92	22.4
k	1.86	2.48	3.1	3.72	4.96	6.2
s	2	2.5	3	4	5	6

● **Material - plating**

Steel 10.9 / Zinc 3Cr. Plated

Steel 10.9 / Zinc Black 3Cr. Plated

pcs / Box

L \ d	M3	M4	M5	M6	M8	M10
5	1000					
6	1000	1000	400			
8	1000	1000	400	400		
10	1000	1000	400	400	200	
12	1000	1000	400	200	100	
14	1000	1000	400	200	100	
15	1000	1000	400	200	100	100
16	1000	1000	400	200	100	100
18	1000	1000	200	200	100	100
20	1000	1000	200	200	100	100
25	800	800	200	200	100	100
30	800	800	200	100	100	100
35	600	600	200	100	100	100
40	800	600	200	100	100	100
45		600	200	100	100	100
50		600	200	100	100	50
55			200	100	100	50
60			200	100	100	50
65					100	50
70					100	50

How to order or inquire: R830-7991-material code diameter x length

Example: R830-7991-TI 4x16

Material codes: TI for Titanium

● **Material TITAN**

pcs / Box

L \ d	M3	M4	M5	M6	M8
6	1000				
8	1000	1000	1000	500	
10	1000	1000	500	500	
12	1000	1000	500	500	200
15	1000	1000	500	500	200
16	1000	1000	500	500	200
20	1000	1000	500	500	200
25		1000	500	500	200
30		1000	500	500	200

HEX SOCKET FLAT HEAD SCREW JIS B1194 / DIN 7991

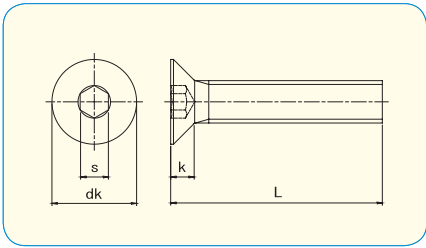

● **Material**
Stainless Steel A2



How to order or inquire: R830-7991A2 diameter x length

Example: R830-7991A2 4x16

Material codes: A2 for Stainless Steel A2

	M3	M4	M5	M6	M8	M10	M12	M14	M16	M20
dk	6.72	8.96	11.2	13.44	17.92	22.4	26.88	30.8	33.6	40.32
k	1.86	2.48	3.1	3.72	4.96	6.2	7.44	8.4	8.8	10.16
s	2	2.5	3	4	5	6	8	10	10	12

		pcs / Box									
L	d	M3	M4	M5	M6	M8	M10	M12	M14	M16	M20
3											
4		500									
5		500	500								
6		500	500	500							
8		500	500	500	300						
10		500	500	500	300	200					
12		500	500	500	300	200					
14		500	500	500	300	200	100				
15		500	500	500	300	200	100				
16		500	500	500	300	200	100				
18		500	500	500	300	200	100				
20		500	500	500	300	200	100	100			
22		500	500	500	300	200	100				
25		500	500	500	300	200	100	100		20	
30		500	500	500	300	200	100	100	20	20	10
35		500	500	500	300	200	100	100		20	10
40		500	500	500	300	200	100	100	20	20	10
45		500	500	500	300	200	100	100		20	10
50		500	500	500	300	200	100	100	20	20	10
55			500	500	300	200	100	100		20	10
60			500	500	300	200	100	100	20	20	10
65				500	300	200	100	100		20	10
70				500	300	200	100	100	20	20	10
75				500	300	200	100	100		20	10
80				500	300	200	100	100	20	20	10
85											
90					300	200	100	100	20	20	10
95											
100					300	200	100	100	20	20	10
110							100				
120							100				
130							100				
140							100				
150							100				