

CROSS RECESS PAN HEAD TAPPING SCREW Class1 , type A JIS B 1122

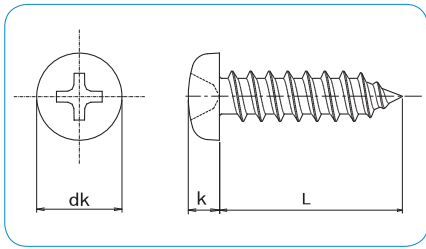

- **Material · plating**
Steel / Zinc 3Cr. Plated
Steel / Zinc Black 3Cr. Plated

- **Thread**
Class1 , Type A



RoHS Directive Compliance

How to order or inquire: R830-B1122-1A-PH-finish code diameter x length

Example: R830-B1122-1A-PH-CR3 2.6X8

Finish codes: CR3 for Zinc 3Cr. Plated, CR3B for Black 3Cr. Plated

| | 2 | 2.3 | 2.6 | 3 | 3.5 | 4 | 4.5 | 5 | 6 |
|------------|-----|-----|-----|-----|-----|-----|-----|-----|------|
| dk | 3.5 | 4.0 | 4.5 | 5.5 | 6.0 | 7.0 | 8.0 | 9.0 | 10.5 |
| k | 1.3 | 1.5 | 1.7 | 2.0 | 2.3 | 2.6 | 2.9 | 3.3 | 3.9 |
| Drive Size | 1 | | | 2 | | | 3 | | |

| | | pcs / Box | | | | | | | | |
|-----|---|-----------|-------|-------|-------|-------|-------|-------|-------|-----|
| d | L | 2 | 2.3 | 2.6 | 3 | 3.5 | 4 | 4.5 | 5 | 6 |
| 3 | | 12,000 | | | | | | | | |
| 4 | | 10,000 | 7,000 | 5,000 | 3,000 | | | | | |
| 5 | | 8,000 | 6,000 | 5,000 | 3,000 | | | | | |
| 6 | | 8,000 | 6,000 | 4,500 | 2,500 | 3,500 | 2,200 | | | |
| 8 | | 6,000 | 5,000 | 3,500 | 2,200 | 2,500 | 2,000 | 1,500 | 1,000 | |
| 10 | | 5,000 | 4,000 | 3,000 | 2,000 | 2,500 | 1,600 | 1,400 | 900 | 600 |
| 12 | | 4,000 | 2,500 | 2,500 | 2,500 | 2,000 | 1,500 | 1,200 | 800 | 600 |
| 14 | | | 2,200 | 2,000 | 2,200 | 1,800 | 1,200 | | 800 | 500 |
| 16 | | 2,500 | 2,200 | 1,800 | 2,000 | 1,600 | 1,000 | 900 | 700 | 450 |
| 18 | | 2,200 | | 1,500 | 1,600 | 1,200 | 1,000 | | 600 | 400 |
| 20 | | 2,000 | 2,200 | 1,500 | 1,500 | 1,200 | 900 | 800 | 500 | 350 |
| 25 | | 1,500 | | 1,000 | 1,200 | 1,000 | 700 | 600 | 700 | 500 |
| 30 | | | | 800 | 1,000 | 800 | 600 | 700 | 600 | 400 |
| 35 | | | | 500 | 700 | * 600 | 500 | 600 | 500 | 300 |
| 40 | | | | 500 | 600 | 700 | 600 | 500 | 400 | 300 |
| 45 | | | | | 800 | 600 | 500 | 400 | 350 | 250 |
| 50 | | | | | 600 | 500 | 450 | 350 | 300 | 200 |
| 55 | | | | | | | 400 | | 250 | 200 |
| 60 | | | | | | 350 | 300 | | 230 | 180 |
| 65 | | | | | | | 300 | | 200 | 150 |
| 70 | | | | | | | 300 | | 200 | 120 |
| 75 | | | | | | | 300 | | 200 | 200 |
| 80 | | | | | | | * 300 | | 200 | 200 |
| 85 | | | | | | | | | | |
| 90 | | | | | | | | | 250 | 170 |
| 95 | | | | | | | | | | |
| 100 | | | | | | | | | 250 | 150 |

* ... Zinc 3Cr. Plated only

CROSS RECESS PAN HEAD TAPPING SCREW Class1 , type A JIS B 1122

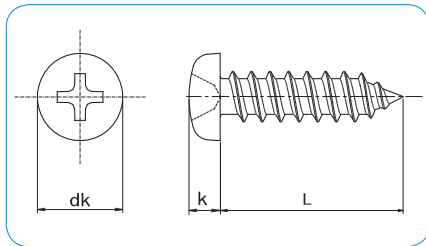

- **Material**
Stainless Steel A2
- **Thread**
Class1 , Type A



How to order or inquire: R830-B1122-1A-PH-material code diameter x length

Example: R830-B1122-1A-PH-A2 2.6X8

Material codes: A2 for Stainless Steel A2

| | 2 | 2.3 | 2.6 | 3 | 3.5 | 4 | 4.5 | 5 | 6 | 8 |
|------------|-----|-----|-----|-----|-----|-----|-----|-----|------|------|
| dk | 3.5 | 4.0 | 4.5 | 5.5 | 6.0 | 7.0 | 8.0 | 9.0 | 10.5 | 14.0 |
| k | 1.3 | 1.5 | 1.7 | 2.0 | 2.3 | 2.6 | 2.9 | 3.3 | 3.9 | 5.2 |
| Drive Size | 1 | | | 2 | | | | 3 | | |

| | | pcs / Box | | | | | | | | | |
|-----|-----|-----------|--------|-------|-------|-------|-------|-------|-----|-----|-----|
| d | L | 2 | 2.3 | 2.6 | 3 | 3.5 | 4 | 4.5 | 5 | 6 | 8 |
| 4 | 4 | 10,000 | 10,000 | 8,000 | | | | | | | |
| 5 | 5 | 10,000 | 8,000 | 6,000 | 3,000 | | | | | | |
| 6 | 6 | 10,000 | 8,000 | 6,000 | 3,000 | | 2,000 | | | | |
| 8 | 8 | 8,000 | 5,000 | 5,000 | 2,000 | 2,000 | 1,000 | 1,000 | | | |
| 10 | 10 | 6,000 | 5,000 | 4,000 | 2,000 | 2,000 | 1,000 | 1,000 | 500 | | |
| 12 | 12 | 6,000 | | 3,000 | 2,000 | 2,000 | 1,000 | 1,000 | 500 | 500 | |
| 14 | 14 | 4,000 | | 3,000 | 2,000 | 1,000 | 1,000 | | 500 | | |
| 16 | 16 | 4,000 | | 3,000 | 1,000 | 1,000 | 1,000 | 500 | 500 | 200 | 200 |
| 18 | 18 | | | | 1,000 | | 500 | | | | |
| 20 | 20 | 3,000 | | 2,000 | 1,000 | 1,000 | 500 | 500 | 500 | 200 | 100 |
| 25 | 25 | | | | 1,000 | 500 | 500 | 500 | 400 | 200 | 100 |
| 30 | 30 | | | | 500 | 500 | 500 | 500 | 200 | 200 | 100 |
| 35 | 35 | | | | 500 | 500 | 500 | 200 | 200 | 200 | 100 |
| 40 | 40 | | | | 500 | 200 | 200 | 200 | 200 | 100 | 50 |
| 45 | 45 | | | | | 200 | 200 | 200 | 200 | 100 | 50 |
| 50 | 50 | | | | | 200 | 200 | 200 | 100 | 100 | 50 |
| 55 | 55 | | | | | | 200 | | 100 | 100 | |
| 60 | 60 | | | | | | 200 | 100 | 100 | 100 | |
| 65 | 65 | | | | | | 200 | 100 | 100 | 100 | |
| 70 | 70 | | | | | | 200 | | 100 | 100 | 50 |
| 75 | 75 | | | | | | 200 | | 100 | 100 | |
| 80 | 80 | | | | | | 200 | | 100 | 100 | 50 |
| 90 | 90 | | | | | | 200 | | 100 | 50 | |
| 100 | 100 | | | | | | 200 | | 100 | 50 | |

CROSS RECESS FLAT HEAD TAPPING SCREW Class1 , type A JIS B 1122

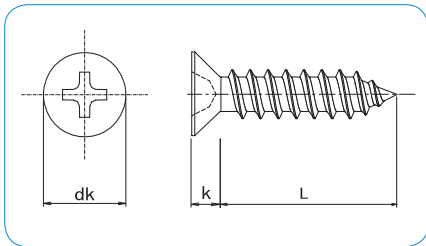

- **Material · plating**
Steel / Zinc 3Cr. Plated
Steel / Zinc Black 3Cr. Plated

- **Thread**
Class1 , Type A



RoHS Directive Compliance

How to order or inquire: R830-B1122-1A-FH-finish code diameter x length

Example: R830-B1122-1A-FH-CR3 2.6X8

Finish codes: CR3 for Zinc 3Cr. Plated, CR3B for Black 3Cr. Plated

| | 2 | 2.3 | 2.6 | 3 | 3.5 | 4 | 4.5 | 5 | 6 | 8 |
|------------|------|------|------|------|------|------|------|------|------|------|
| dk | 4.0 | 4.6 | 5.2 | 6.0 | 7.0 | 8.0 | 9.0 | 10.0 | 12.0 | 16.0 |
| k | 1.20 | 1.35 | 1.50 | 1.75 | 2.00 | 2.30 | 2.55 | 2.80 | 3.40 | 4.40 |
| Drive Size | 1 | | | 2 | | | | 3 | | |

| | | pcs / Box | | | | | | | | | |
|-----|-----|-----------|-------|-------|-------|-------|-------|-------|-------|-----|-----|
| d | L | 2 | 2.3 | 2.6 | 3 | 3.5 | 4 | 4.5 | 5 | 6 | 8 |
| 4 | 4 | 10,000 | | | | | | | | | |
| 5 | 5 | 10,000 | | | | | | | | | |
| 6 | 6 | 9,000 | 6,000 | 5,000 | 3,500 | | | | | | |
| 8 | 8 | 9,000 | 5,000 | 4,000 | 2,500 | 3,000 | 2,000 | | | | |
| 10 | 10 | 5,000 | 4,000 | 3,000 | 2,200 | 2,500 | 1,800 | 1,500 | 1,100 | | |
| 12 | 12 | 4,000 | 2,500 | 2,500 | 2,500 | 2,000 | 1,500 | 1,300 | 1,000 | 600 | |
| 14 | 14 | | 2,200 | 2,000 | 2,500 | 1,800 | 1,200 | 1,000 | 800 | 500 | |
| 16 | 16 | 3,000 | 2,200 | 1,800 | 2,000 | 1,600 | 1,200 | 1,000 | 700 | 500 | |
| 18 | 18 | | | 1,500 | 1,800 | 1,200 | 1,000 | | | | |
| 20 | 20 | | | 1,500 | 1,500 | 1,200 | 900 | 800 | 600 | 400 | 200 |
| 25 | 25 | | | 1,000 | 1,200 | 1,000 | 700 | 600 | 700 | 500 | 220 |
| 30 | 30 | | | 800 | 1,000 | 800 | 600 | 700 | 600 | 400 | 200 |
| 35 | 35 | | | | 700 | 600 | 500 | 600 | 500 | 300 | 180 |
| 40 | 40 | | | | 600 | 700 | 600 | 500 | 400 | 300 | 160 |
| 45 | 45 | | | | 800 | 600 | 500 | 400 | 350 | 250 | 150 |
| 50 | 50 | | | | 600 | 500 | 450 | 350 | 300 | 200 | 130 |
| 55 | 55 | | | | | | 400 | | 250 | 200 | |
| 60 | 60 | | | | | 350 | 300 | | 230 | 180 | |
| 65 | 65 | | | | | | 300 | | 200 | 150 | |
| 70 | 70 | | | | | | 300 | | 200 | 150 | |
| 75 | 75 | | | | | | 300 | | 200 | 200 | |
| 80 | 80 | | | | | | 300 | | 200 | 200 | |
| 85 | 85 | | | | | | | | | | |
| 90 | 90 | | | | | | 350 | | 250 | 170 | |
| 95 | 95 | | | | | | | | | | |
| 100 | 100 | | | | | | 300 | | 250 | 150 | |

* ... Zinc 3Cr. Plated only

CROSS RECESS FLAT HEAD TAPPING SCREW Class1 ,type A JIS B 1122

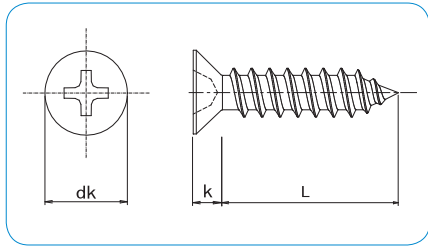

- **Material**
Stainless Steel A2
- **Thread**
Class1 , Type A



How to order or inquire: R830-B1122-1A-FH-material code diameter x length

Example: R830-B1122-1A-FH-A2 2.6X8

Material codes: A2 for Stainless Steel A2

| | 2 | 2.6 | 3 | 3.5 | 4 | 4.5 | 5 | 6 | 8 | |
|------------|------|------|------|------|------|------|------|------|------|--|
| dk | 4.0 | 5.2 | 6.0 | 7.0 | 8.0 | 9.0 | 10.0 | 12.0 | 16.0 | |
| k | 1.20 | 1.50 | 1.75 | 2.00 | 2.30 | 2.55 | 2.80 | 3.40 | 4.40 | |
| Drive Size | 1 | | 2 | | | | | 3 | | |

| | | pcs / Box | | | | | | | | |
|-----|--------|-----------|-------|-------|-------|-------|-----|-----|-----|---|
| d | L | 2 | 2.6 | 3 | 3.5 | 4 | 4.5 | 5 | 6 | 8 |
| 5 | 10,000 | | | | | | | | | |
| 6 | 10,000 | 6,000 | 3,000 | | | | | | | |
| 8 | 8,000 | 5,000 | 2,000 | 2,000 | 2,000 | | | | | |
| 10 | 6,000 | 4,000 | 2,000 | 2,000 | 1,000 | | | | | |
| 12 | 6,000 | 3,000 | 2,000 | 2,000 | 1,000 | 1,000 | 500 | | | |
| 14 | | 3,000 | 2,000 | 1,000 | 1,000 | | 500 | | | |
| 16 | 3,000 | 2,000 | 1,000 | 1,000 | 1,000 | 500 | 500 | 200 | 200 | |
| 18 | | 2,000 | 1,000 | 1,000 | 500 | | | | | |
| 20 | | 2,000 | 1,000 | 1,000 | 500 | 500 | 500 | 200 | 100 | |
| 25 | | 1,000 | 1,000 | 500 | 500 | 500 | 500 | 200 | 100 | |
| 30 | | 1,000 | 500 | 500 | 500 | 500 | 200 | 200 | 100 | |
| 35 | | | 500 | 500 | 500 | 200 | 200 | 200 | 100 | |
| 40 | | | 500 | 200 | 200 | 200 | 200 | 100 | 50 | |
| 45 | | | | 200 | 200 | 200 | 200 | 100 | 50 | |
| 50 | | | | 200 | 200 | 200 | 100 | 100 | 50 | |
| 55 | | | | | 200 | 400 | 100 | 100 | | |
| 60 | | | | | 200 | 200 | 100 | 100 | 50 | |
| 65 | | | | | 200 | | 100 | 100 | 50 | |
| 70 | | | | | 200 | | 100 | 100 | 50 | |
| 75 | | | | | 200 | | 100 | 100 | | |
| 80 | | | | | 200 | | 100 | 100 | 50 | |
| 90 | | | | | 200 | | 100 | 50 | | |
| 100 | | | | | 200 | | 100 | 50 | | |

CROSS RECESS OVAL HEAD TAPPING SCREW Class1, type A JIS B 1122

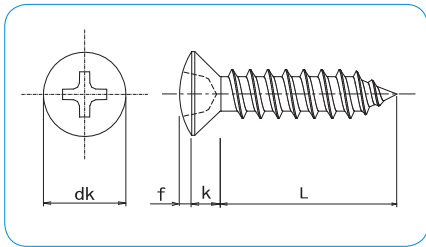

- **Material · plating**
Steel / Zinc 3Cr. Plated
Steel / Zinc Black 3Cr. Plated

- **Thread**
Class1 , Type A



RoHS Directive Compliance

How to order or inquire: R830-B1122-1A-OH-finish code diameter x length

Example: R830-B1122-1A-OH-CR3 2.6X8

Finish codes: CR3 for Zinc 3Cr. Plated, CR3B for Black 3Cr. Plated

| | 2 | 2.3 | 2.6 | 3 | 3.5 | 4 | 4.5 | 5 | 6 |
|------------|-----|------|-----|------|-----|-----|------|-----|-----|
| dk | 4 | 4.6 | 5.2 | 6 | 7 | 8 | 9 | 10 | 12 |
| k | 1.2 | 1.35 | 1.5 | 1.75 | 2 | 2.3 | 2.55 | 2.8 | 3.4 |
| f | 0.4 | 0.5 | 0.6 | 0.7 | 0.8 | 0.9 | 1 | 1.2 | 1.4 |
| Drive Size | 1 | | | 2 | | | 3 | | |

| | | pcs / Box | | | | | | | |
|-------|--------|-----------|-------|-------|-------|-------|-------|-----|-----|
| L \ d | 2 | 2.3 | 2.6 | 3 | 3.5 | 4 | 4.5 | 5 | 6 |
| 5 | 10,000 | | | | | | | | |
| 6 | 8,000 | | 5,000 | 2,500 | | | | | |
| 8 | 6,000 | 5,000 | 3,500 | 2,200 | 3,000 | 2,000 | | | |
| 10 | 5,000 | | 3,000 | 2,000 | 2,500 | 1,600 | 1,400 | 900 | |
| 12 | | 2,500 | 2,500 | 2,500 | 2,000 | 1,500 | 1,200 | 800 | |
| 14 | | | | 2,200 | 1,800 | 1,200 | | | |
| 16 | | | 1,800 | 2,000 | 1,600 | 1,000 | 900 | 700 | 450 |
| 18 | | | | 1,600 | 1,200 | | | 600 | |
| 20 | | | | 1,500 | 1,200 | 900 | 800 | 500 | 350 |
| 25 | | | | 1,200 | 1,000 | 700 | 600 | 700 | 500 |
| 30 | | | | 1,000 | 800 | 600 | 700 | 600 | 400 |
| 35 | | | | 700 | 600 | 500 | 600 | 500 | 300 |
| 40 | | | | 600 | 700 | 600 | 500 | 400 | 300 |
| 45 | | | | | 600 | 500 | 400 | 350 | 250 |
| 50 | | | | 600 | 500 | 450 | 350 | 300 | 200 |
| 55 | | | | | | 400 | | | |
| 60 | | | | | | 300 | | 230 | |
| 65 | | | | | | 300 | | 200 | |
| 70 | | | | | | 300 | | | |
| 75 | | | | | | 300 | | | |
| 80 | | | | | | 300 | | | |
| 85 | | | | | | | | | |
| 90 | | | | | | 300 | | | |

* ... Zinc 3Cr. Plated only

CROSS RECESS OVAL HEAD TAPPING SCREW Class1 , type A JIS B 1122

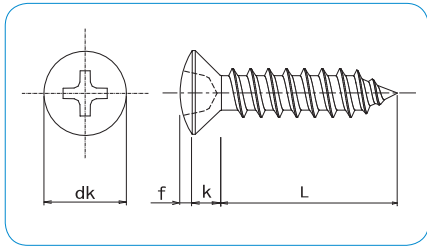

- **Material**
Stainless Steel A2
- **Thread**
Class1 , Type A



How to order or inquire: R830-B1122-1A-OH-material code diameter x length

Example: R830-B1122-1A-OH-A2 2.6X8

Material codes: A2 for Stainless Steel A2

| | 2 | 2.6 | 3 | 3.5 | 4 | 4.5 | 5 | 6 |
|------------|-----|-----|------|-----|-----|------|-----|-----|
| dk | 4 | 5.2 | 6 | 7 | 8 | 9 | 10 | 12 |
| k | 1.2 | 1.5 | 1.75 | 2 | 2.3 | 2.55 | 2.8 | 3.4 |
| f | 0.4 | 0.6 | 0.7 | 0.8 | 0.9 | 1 | 1.2 | 1.4 |
| Drive Size | 1 | | | 2 | | | 3 | |

| | | pcs / Box | | | | | | | |
|----|---|-----------|-------|-------|-------|-------|-------|-----|-----|
| d | L | 2 | 2.6 | 3 | 3.5 | 4 | 4.5 | 5 | 6 |
| 6 | | 10,000 | | | | | | | |
| 8 | | | 5,000 | 2,000 | 2,000 | 2,000 | | | |
| 10 | | | 4,000 | 2,000 | 2,000 | 1,000 | | | |
| 12 | | | 3,000 | 2,000 | 2,000 | 1,000 | 1,000 | 500 | |
| 14 | | | 3,000 | 2,000 | 1,000 | | | | |
| 16 | | | 2,000 | 1,000 | 1,000 | 1,000 | 500 | 500 | 200 |
| 18 | | | | | | | | | |
| 20 | | | 2,000 | 1,000 | 1,000 | 500 | 500 | 500 | 200 |
| 25 | | | 1,000 | 1,000 | 500 | 500 | 500 | 400 | 200 |
| 30 | | | 1,000 | 500 | 500 | 500 | 500 | 200 | 200 |
| 35 | | | | | | 500 | | 200 | 200 |
| 40 | | | | | | 200 | | 200 | 100 |
| 45 | | | | | | 200 | | 200 | 100 |
| 50 | | | | | | 200 | 200 | 100 | 100 |
| 55 | | | | | | 200 | | 200 | |
| 60 | | | | | | 200 | | 100 | |
| 65 | | | | | | | | 100 | |
| 70 | | | | | | | | 100 | |
| 75 | | | | | | | | 100 | |

CROSS RECESS TRUSS HEAD TAPPING SCREW Class1 , type A JIS B 1122

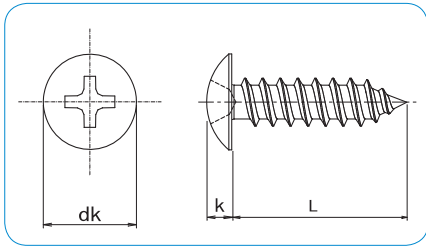

- **Material · plating**
Steel / Zinc 3Cr. Plated
Steel / Zinc Black 3Cr. Plated
- **Thread**
Class1 , Type A



How to order or inquire: R830-B1122-1A-TRH-finish code diameter x length

Example: R830-B1122-1A-TRH-CR3 2.6X8

Finish codes: CR3 for Zinc 3Cr. Plated, CR3B for Black 3Cr. Plated

| | 2 | 2.6 | 3 | 3.5 | 4 | 4.5 | 5 | 6 |
|------------|-----|-----|-----|-----|-----|------|------|-----|
| dk | 4.5 | 5.9 | 6.9 | 8.1 | 9.4 | 10.6 | 11.8 | 14 |
| k | 1.2 | 1.6 | 1.9 | 2.2 | 2.5 | 2.8 | 3.1 | 3.7 |
| Drive Size | 1 | | | 2 | | | 3 | |

| | | pcs / Box | | | | | | | |
|-----|---|-----------|-------|-------|-------|-------|-------|-----|-----|
| d | L | 2 | 2.6 | 3 | 3.5 | 4 | 4.5 | 5 | 6 |
| 5 | | 7,000 | | 2,500 | | | | | |
| 6 | | 6,000 | 3,500 | 2,200 | 2,500 | 1,600 | | | |
| 8 | | 5,000 | 3,000 | 1,800 | 2,000 | 1,500 | | 800 | |
| 10 | | 4,000 | 2,500 | 1,800 | 1,800 | 1,200 | 1,000 | 800 | 400 |
| 12 | | 3,000 | 2,000 | 2,200 | 1,600 | 1,200 | 1,000 | 700 | 400 |
| 14 | | | | 2,000 | 1,400 | 1,000 | | 600 | 400 |
| 16 | | | 1,500 | 1,800 | 1,200 | 900 | 800 | 500 | 350 |
| 18 | | | | 1,500 | 1,000 | 800 | | 450 | |
| 20 | | | 1,200 | 1,400 | 1,000 | 700 | 600 | 450 | 300 |
| 25 | | | | 1,000 | 800 | 600 | 500 | 500 | 400 |
| 30 | | | | 800 | 600 | 500 | 600 | 500 | 300 |
| 35 | | | | 700 | 500 | 400 | 500 | 400 | 300 |
| 40 | | | | 500 | 600 | 500 | 400 | 350 | 250 |
| 45 | | | | 700 | 500 | 450 | 350 | 300 | 200 |
| 50 | | | | 600 | 450 | 400 | 300 | 250 | 180 |
| 55 | | | | | | 350 | | 230 | 150 |
| 60 | | | | | 300 | 300 | | 200 | 150 |
| 65 | | | | | | 250 | | 180 | 120 |
| 70 | | | | | | 250 | | 180 | 120 |
| 75 | | | | | | 200 | | 150 | 160 |
| 80 | | | | | | 200 | | 150 | 160 |
| 85 | | | | | | | | | |
| 90 | | | | | | 200 | | 130 | 150 |
| 95 | | | | | | | | | |
| 100 | | | | | | 200 | | 130 | 150 |

* ... Zinc 3Cr. Plated only

CROSS RECESS TRUSS HEAD TAPPING SCREW Class1 , type A JIS B 1122

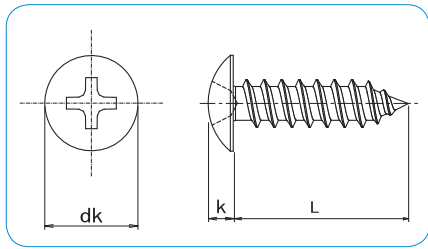

- **Material**
Stainless Steel A2
- **Thread**
Class1 , Type A



How to order or inquire: R830-B1122-1A-TRH-material code diameter x length

Example: R830-B1122-1A-TRH-A2 2.6X8

Material codes: A2 for Stainless Steel A2

| | 2.6 | 3 | 3.5 | 4 | 4.5 | 5 | 6 | 8 |
|------------|-----|-----|-----|-----|------|------|-----|------|
| dk | 5.9 | 6.9 | 8.1 | 9.4 | 10.6 | 11.8 | 14 | 17.8 |
| k | 1.6 | 1.9 | 2.2 | 2.5 | 2.8 | 3.1 | 3.7 | 4.8 |
| Drive Size | 1 | | 2 | | | | 3 | |

| | | pcs / Box | | | | | | | |
|-------|-------|-----------|-------|-------|-------|-----|-----|-----|--|
| L \ d | 2.6 | 3 | 3.5 | 4 | 4.5 | 5 | 6 | 8 | |
| 5 | | 2,000 | | | | | | | |
| 6 | | 2,000 | | 1,000 | | | | | |
| 8 | 3,000 | 2,000 | 2,000 | 1,000 | | 500 | | | |
| 10 | 3,000 | 2,000 | 1,000 | 1,000 | 1,000 | 500 | | | |
| 12 | | 2,000 | 1,000 | 1,000 | 500 | 500 | 200 | | |
| 14 | | 1,000 | 1,000 | 500 | 500 | 500 | | | |
| 16 | | 1,000 | 1,000 | 500 | 500 | 500 | 200 | 200 | |
| 18 | | | | 500 | | | | | |
| 20 | | 1,000 | 500 | 500 | 500 | 400 | 200 | 100 | |
| 25 | | 500 | 500 | 500 | 500 | 200 | 200 | 100 | |
| 30 | | 500 | 500 | 500 | 200 | 200 | 200 | 100 | |
| 35 | | | 500 | 200 | 200 | 200 | 100 | 50 | |
| 40 | | | 200 | 200 | 200 | 200 | 100 | 50 | |
| 45 | | | 200 | 200 | 200 | 100 | 100 | 50 | |
| 50 | | | 200 | 200 | 200 | 100 | 100 | 50 | |
| 55 | | | | 200 | | 100 | 100 | | |
| 60 | | | | 200 | | 100 | 100 | 50 | |
| 65 | | | | 200 | | 100 | 100 | | |
| 70 | | | | 200 | | 100 | 100 | 50 | |
| 75 | | | | 200 | | 100 | | | |
| 80 | | | | | | 100 | | 50 | |

CROSS RECESS BINDING HEAD TAPPING SCREW Class1 , type A JIS B 1122

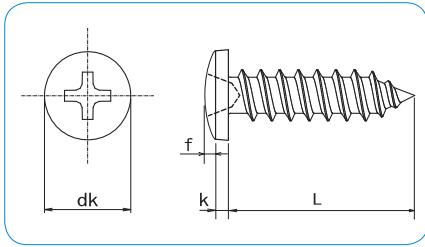

- **Material - plating**
Steel / Zinc 3Cr. Plated
Steel / Zinc Black 3Cr. Plated
- **Thread**
Class1 , Type A



RoHS Directive Compliance

How to order or inquire: R830-B1122-1A-BDH-finish code diameter x length

Example: R830-B1122-1A-BDH-CR3 2.6X8

Finish codes: CR3 for Zinc 3Cr. Plated, CR3B for Black 3Cr. Plated

| | 2 | 2.6 | 3 | 3.5 | 4 | 4.5 | 5 | 6 |
|------------|-----|-----|-----|-----|-----|-----|------|------|
| dk | 4.3 | 5.5 | 6.3 | 7.3 | 8.3 | 9.3 | 10.3 | 12.4 |
| k+f | 1.2 | 1.6 | 1.9 | 2.2 | 2.5 | 2.8 | 3.1 | 3.7 |
| Drive Size | 1 | | 2 | | | | 3 | |

| | | pcs / Box | | | | | | | |
|----|---|-----------|-------|-------|-------|-------|-------|-----|-----|
| d | L | 2 | 2.6 | 3 | 3.5 | 4 | 4.5 | 5 | 6 |
| 5 | | 7,000 | 4,000 | 2,500 | | | | | |
| 6 | | 6,000 | 3,500 | 2,200 | 2,500 | 1,600 | | | |
| 8 | | 5,000 | 3,000 | 1,800 | 2,000 | 1,500 | | 800 | |
| 10 | | 4,000 | 2,500 | 1,800 | 1,800 | 1,200 | 1,000 | 800 | |
| 12 | | | 2,000 | 2,200 | 1,600 | 1,200 | 1,000 | 700 | 400 |
| 14 | | | | 2,000 | 1,400 | 1,000 | 800 | 600 | |
| 16 | | | 1,500 | 1,800 | 1,200 | 900 | 800 | 500 | 350 |
| 18 | | | | 1,500 | 1,000 | 800 | | 450 | |
| 20 | | | | 1,400 | 1,000 | 700 | 600 | 450 | 300 |
| 25 | | | | 1,000 | 800 | 600 | 500 | 500 | 400 |
| 30 | | | | 800 | 600 | 500 | 600 | 500 | 300 |
| 35 | | | | 700 | 500 | 400 | 500 | 400 | 300 |
| 40 | | | | | 600 | 500 | 400 | 350 | 250 |
| 45 | | | | | 500 | 450 | | 300 | 200 |
| 50 | | | | | 450 | 500 | 300 | 250 | 180 |
| 55 | | | | | | | | | |
| 60 | | | | | | | | 200 | |
| 65 | | | | | | | | | |
| 70 | | | | | | 300 | | 180 | |
| 75 | | | | | | | | 150 | |

* ... Zinc 3Cr. Plated only

CROSS RECESS BINDING HEAD TAPPING SCREW Class1 , type A JIS B 1122

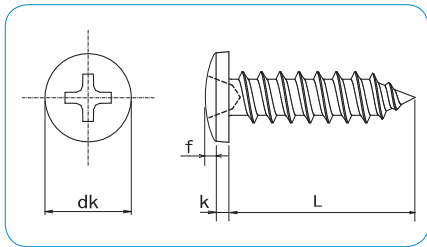

- **Material**
Stainless Steel A2
- **Thread**
Class1 , Type A



How to order or inquire: R830-B1122-1A-BDH-material code diameter x length

Example: R830-B1122-1A-BDH-A2 2.6X8

Material codes: A2 for Stainless Steel A2

| | 2.6 | 3 | 3.5 | 4 | 4.5 | 5 | 6 |
|------------|-----|-----|-----|-----|-----|------|------|
| dk | 5.5 | 6.3 | 7.3 | 8.3 | 9.3 | 10.3 | 12.4 |
| k+f | 1.6 | 1.9 | 2.2 | 2.5 | 2.8 | 3.1 | 3.7 |
| Drive Size | 1 | 2 | | | | | 3 |

| | | pcs / Box | | | | | | |
|----|---|-----------|-------|-------|-------|-------|-----|-----|
| d | L | 2.6 | 3 | 3.5 | 4 | 4.5 | 5 | 6 |
| 6 | | | 2,000 | | | | | |
| 8 | | | 2,000 | 1,000 | 1,000 | | | |
| 10 | | | 2,000 | 1,000 | 1,000 | 1,000 | 500 | |
| 12 | | 3,000 | 2,000 | 1,000 | 1,000 | 500 | 500 | 200 |
| 14 | | 2,500 | 1,000 | 1,000 | 500 | 500 | | |
| 16 | | 2,000 | 1,000 | 1,000 | 500 | 500 | 500 | 200 |
| 18 | | | | | | | | |
| 20 | | | 1,000 | 500 | 500 | 500 | 400 | 200 |
| 25 | | | 500 | 500 | 500 | 500 | 200 | 200 |
| 30 | | | 1,000 | 500 | 500 | 200 | 200 | 200 |
| 35 | | | | | 200 | | 200 | 100 |
| 40 | | | | | 200 | | 200 | |
| 45 | | | | | 200 | | | |
| 50 | | | | | 200 | | | |